

SOUTH BEACH



SOUTH BEACH

2023 FUNCTIONS &
LOUNGE BOOKINGS



Slice of Paradise

WHAT WE CONSIDER OUR LITTLE SLICE OF PARADISE, SOUTHBEACH IS A WATERFRONT OASIS NESTLED IN THE HUSTLING AND BUSTLING HEART OF SOUTH BANK, BRISBANE. DURING THE DAY, GUESTS CAN SOAK UP THE SUN WITH OUTDOOR DINING, OR KICK BACK IN ONE OF OUR LOUNGE AREAS AS THEY SIP THE DAY AWAY.

AS THE SUN GOES DOWN, THE BRISBANE CITY LIGHTS TURN ON AND SOUTHBEACH TRANSFORMS INTO A WATERFRONT BAR WITH LIVE MUSIC, ELECTRIC ATMOSPHERE AND A MENU TO MATCH! KNOWN FOR OUR SHARE PLATES AND TROPICAL COCKTAILS, SUMMER NEVER ENDS AT SOUTHBEACH.

FOR MORE INFORMATION OR A PRIVATE TOUR OF THE VENUE,
CONTACT OUR EVENTS MANAGER AT
EVENTS@SOUTHBEACH.NET.AU
OR CALL 0401 278 562





Sunset Lounges

GRAB THE GANG AND BOOK A SUNSET LOUNGE FOR ANY OCCASION!

Our Sunset Lounges offer the best of both worlds - the relaxed atmosphere of South Bank's iconic beaches, and the bustling buzz of our bar and restaurant.

Select from our canapes and lounge menus. Sunset lounges can comfortably accommodate up to 12 people each. Combine them for larger groups!

	CAPACITY
<u>1 LOUNGE</u>	<u>12 GUESTS</u>
<u>2 LOUNGES</u>	<u>24 GUESTS</u>

Cabana Lounge

NESTLED UNDER A PICTURESQUE WHITE CANOPY IS OUR CABANA LOUNGE

Perfect for groups of up to 12, the Cabana Lounge is a semi-private section with plenty of room for a spread of canapes and cocktail jugs to share!

Located near the main bar, you will still feel amongst the buzzing atmosphere of Southbeach, whilst maintaining privacy and exclusivity.

CAPACITY

CABANA LOUNGE 12 GUESTS





Lower Beach Deck

OUR BEACH DECK IS REMINISCENT OF A DAY BY THE OCEAN.

With a sprawling open-air area and market umbrellas to keep you protected from the elements. High bars allow privacy from the general public without making your guests feel closed off to the rest of the venue, and most importantly the main bar!

Background music is available for this area, with options ranging from live acoustics to in-house tunes.

COCKTAIL STYLE

CAPACITY
40 GUESTS

**Not wheelchair accessible for Lower Beach Deck functions*



The Bungalow

THE BUNGALOW HAS BEACH TO CITY VIEWS, PROVIDING THE PERFECT BACKDROP FOR YOUR EVENT.

Located upstairs, The Bungalow allows privacy for up to 100 guests, without being too closed off thanks to the open balcony with sweeping views of Streets Beach, The Brisbane River and the CBD.

Whether it's a conference, social celebration or seated occasion, The Bungalow is a complete blank canvas that can be easily customised to suit your event.

FACILITIES

- Private bar
- AV facilities: microphone, aux connectivity, plasma screen
- Guests are welcome to bring in their own entertainment
- Perfect for conferences, baby showers, christenings, birthdays and wedding receptions

U-SHAPED

CAPACITY
30 GUESTS

SEATED

50 GUESTS

COCKTAIL STYLE

100 GUESTS





Sunset Bar

BRISBANE'S ICONIC CITY SKYLINE AND SOUTH BANK'S BREEZY BEACH VIBE MELT INTO ONE AT SUNSET BAR, OFFERING THE ULTIMATE SPOT FOR A RELAXED, SOCIAL CELEBRATION.

Sunset Bar is a private area directly in front of our main bar providing privacy in a convenient location for you & your guests.

High tables and comfy stools leave plenty of room to see the view, and space for your guests to mingle. Please note on Fridays, Saturdays and Sundays an acoustic guitarist performs in this space.

COCKTAIL STYLE

CAPACITY
70 GUESTS

BEACH

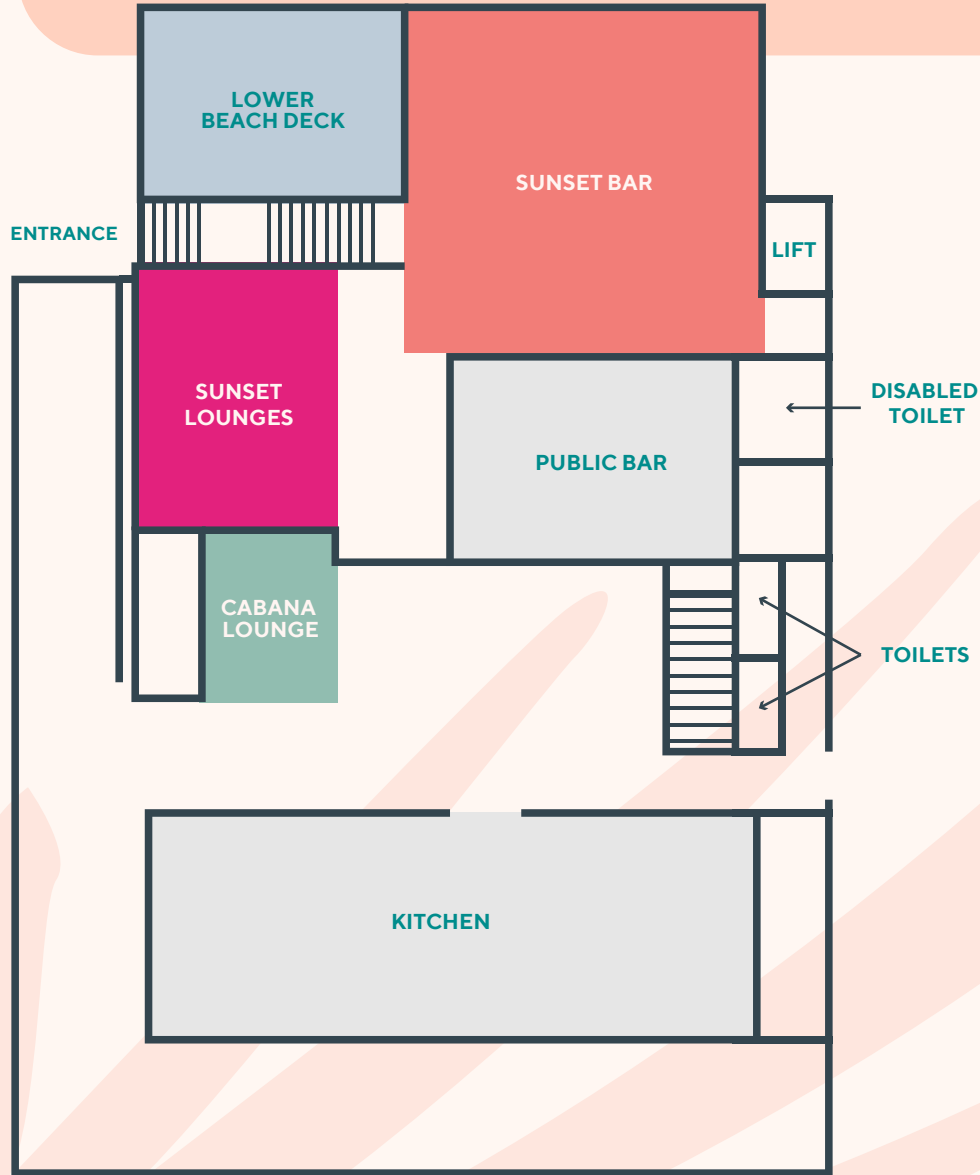

GROUND FLOOR

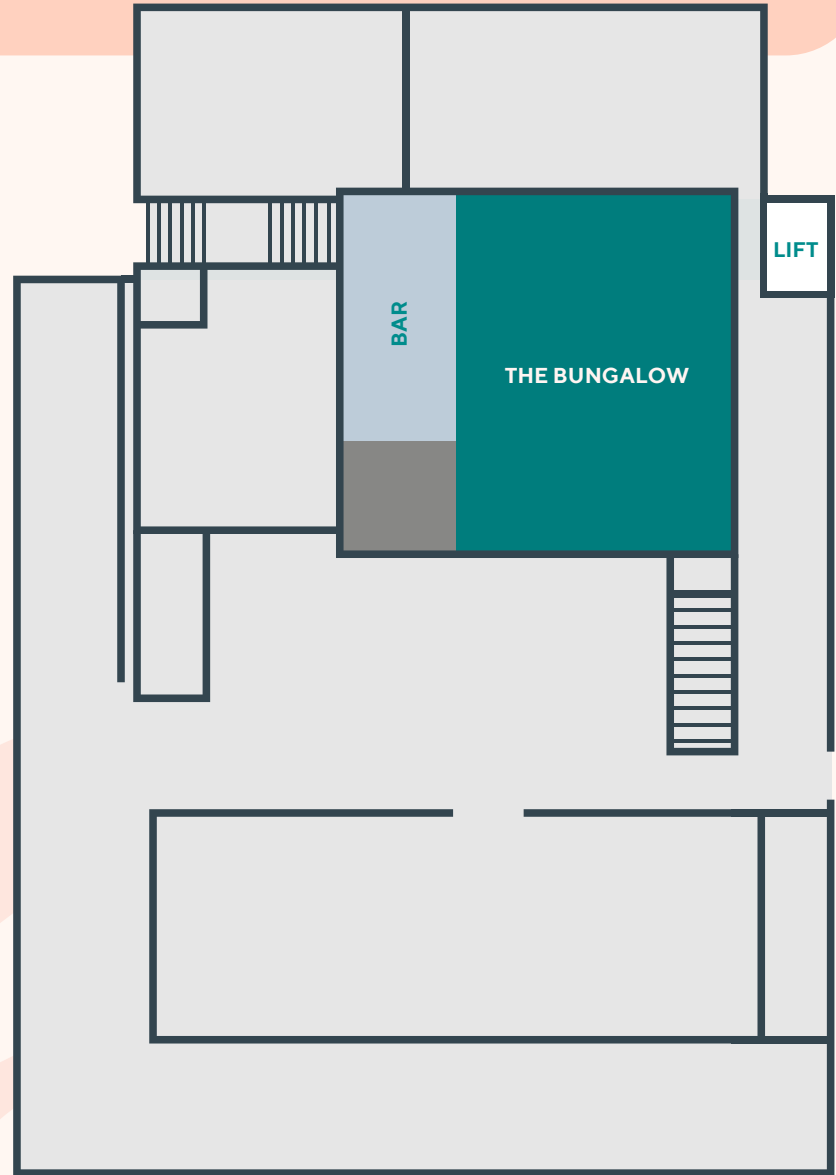

TOP FLOOR



Full Venue Exclusive

Take your event to the next level and enjoy a completely exclusive function. Utilise all five of Southbeach stunning function spaces plus our balconies to host your private event. Enjoy every aspect of the open air venue with stylish decor & tropical gardens, overlooking the city skyline and Brisbane river.

Enquiry directly to our events team regarding a customised function package.

Canapes

\$35PP - Select 4 standard options and 1 premium option

\$45PP - Select 5 standard options and 1 premium option

\$65PP - Select 6 standard and 2 premium options

STANDARD [Extra canapes can be added at a cost of \$4.50pp]

KARAAGE CHICKEN BITES Crunchy fried karaage style chicken pieces with either a teriyaki mayo or dragons breath dipping sauce [GF, DF]

BESAN CAULIFLOWER PIECES Fried cauliflower bites coated in a moroccan spiced batter served with beetroot hummus and sprinkled with dukkha [V, DF, GF]

BANGALOW PORK BELLY Our famous pork belly bites, smothered in sweet plum sauce and sprinkled with our house szechuan spice [GF, DF]

PORK AND CHIVE GYOZAS Pan steamed dumplings with tonkatsu and a citrus ponzu sauce [DF]

COCKTAIL SPRING ROLLS Bite sized vegetarian spring rolls served with a sweet chilli dip [VEG, DF]

TEMPURA FISH BITES Barramundi pieces coated in a light tempura batter and deep fried until golden [DF, GF]

SZECHUAN CALAMARI Crispy fried baby squid, dusted with our house szechuan seasoning served with lime pepper aioli [GF, DF]

PREMIUM [Extra canapes can be added at a cost of \$9pp]

OYSTERS Please select from the below 3 options:

NATURAL with red wine mignonette

KILPATRICK with spiced bacon and lime wedges

MORNAY with cheese sauce

LAMB FINGER SALAD Smoked lamb rib fingers tossed through a coriander, mint and sesame leaf salad [GF]

PULLED PORK SLIDER Pulled pork Southbeach style, with slaw and red cheddar cheese on a bunz slider bun

CHEESEBURGER SLIDER Smashed wagyu pattie, house seasoning, crunchy pickle, American mustard and red cheddar on a bunz slider

VEGETARIAN SLIDER House made felafel pattie with gem lettuce, vegan cheddar and beetroot relish [V]

CAJUN BEEF SKEWERS With mint yoghurt and rocket [GF]

(Please let us know of dietary requirements at time of booking)

(Menu is subject to change, in accordance with seasonal produce)



Seated Function Platters

OUR PLATTERS ARE SERVED FAMILY STYLE THROUGHOUT THE CENTRE OF THE TABLE. PERFECT FOR BIRTHDAYS, SMALL DINNER PARTIES OR CASUAL FUNCTIONS. ALL ITEMS ARE SERVED AS ONE PLATE BETWEEN TWO PEOPLE, OTHER THAN DESSERTS WHICH ARE SERVED ONE PER PERSON.

\$65PP

MB2+ FLANK STEAK Chargrilled and seasoned served over crispy panfried chats and confit baby capsicums [GF]

CRISPY SKINNED GOLDBAND SNAPPER With wild rice and quinoa with a lemon butter sauce [GF]

STEAMED SEASONAL GREENS With toasted almonds and butter [GF]

PAPAYA SALAD Fresh green papaya, mesclun, cherry tomatoes, red onion and nam jin dressing [GF, DF, V]

CAJUN CHICKPEA AND BEETROOT SALAD Fried chickpeas dusted with our cajun spice, beetroot bites, slaw, carrot, alfalfa sprouts and a sesame lime dressing [V, GF]

CHIPS Golden fried potato chips dusted with our special Southbeach seasoning [V, GF, DF]

\$80PP

MB3+ SCOTCH FILLET With café butter and lemon on a bed of crispy panfried chats [GF]

OVEN ROASTED PORTUGUESE SPICED ½ CHICKEN With chimichurri and lemon wedges [GF, DF]

CHOICE OF TWO MENU SALADS: [Select]

CAESAR SALAD Crispy baby cos lettuce, crunchy croutons, shredded bacon, shaved parmesan and our house Caesar dressing, served with a soft poached egg.

LAMB RIB FINGER SALAD Spicy smoked lamb rib fingers, tossed through a coriander and mint salad with a creamy sesame and lime dressing [GF]

CAJUN CHICKPEA AND BEETROOT BOWL Cajun fried chickpeas and diced beetroot with dryslaw, coriander, mint, alfalfa sprouts, sesame seeds and fried shallots served in a sesame dressing with lime [GF, V]

SOUTHBEACH POKE BOWL Fresh sushi style rice, raw salmon cubes, pickled ginger, shaved radishes and nori sheets, served with a soy ponzu dipping sauce [GF, DF]

STEAMED EDAMAME With nori and sesame seeds with a citrus ponzu sauce [GF, DF]

CHIPS Golden fried potato chips dusted with our specialised sobe seasoning [V,GF, DF]

DESSERT SELECTION: [Select one]

CHOCOLATE BROWNIE CUPS with minted cream

MERINGUE NEST with lime curd and fresh berries

DUO OF ICE CREAMS with biscotti





Seated Alternate Drop Functions

OUR ALTERNATE DROP FUNCTION MENU CATERS TO MORE FORMAL OR INTIMATE FUNCTION SETTINGS - WEDDINGS, CORPORATE EVENTS AND BIRTHDAYS. GUESTS MAY SELECT FROM OUR TWO OR THREE COURSE MEALS. EACH IS SERVED WITH A WARM BREAD ROLL AND BUTTER TO START.

\$69PP 2 COURSES (Entrée/ Main or Main/ Dessert)

\$85PP 3 COURSE (Entrée/ Main/ Dessert)

ENTREES

SZECHUAN CALAMARI Crispy fried baby squid, dusted with our house szechuan seasoning served with lime pepper aioli [GF, DF]

KARAAGE BITES Crunchy fried karaage style chicken pieces with either a teriyaki mayo or dragons breath dipping sauce [DF, GF]

LAMB FINGER SALAD Smoked lamb rib fingers tossed through a coriander, mint and sesame leaf salad [DF, GF]

BANGALOW PORK BELLY Bite sized pieces smothered in sticky plum sauce, served with beetroot puree and Murray River pink salt

MAINS

MB3+ SCOTCH FILLET Chargrilled to medium rare served on crunchy golden chats with a lemon café butter [GF]

MB2+ FLANK STEAK Chargrilled to medium rare served on crunchy golden chats and with a red wine veal jus [GF]

PORTUGUESE SPICED ½ CHICKEN Oven roasted till golden with fresh herb chimmichurri and mixed lettuce leaves [GF, DF]

CRISPY SKIN GOLDBAND SNAPPER With warmed wild rice and quinoa with a lemon butter sauce [GF]

SPINACH AND RICOTTA CANNELLONI Hand filled pasta with rich tomato sugo and garlic bread [V]

VEGAN STACKER Seasonal chargrilled vegetables layered in a tower with vegan cheese, beetroot hummus and a sweet balsamic glaze [V, DF, GF]

DESSERTS

BAKED CHOCOLATE CUP Warm baked chocolate pudding served with a vanilla bean ice cream

MERINGUE NEST Fresh meringue nest, seasonal mixed berries a tart lime curd and crème chantilly

GELATO DUO W/ BISCOTTI Seasonal mixed gelatos, served in a cup with housemade chocolate hazelnut biscotti

LIME PANNA COTTA Tart lime panna cotta with coconut shreds and dehydrated limes

Gluten free options available - please request at time of booking



Lounge Booking Menus

OUR LOUNGES ARE THE PERFECT BACKDROP TO YOUR HENS PARTY, BIRTHDAY BASH OR OTHER CASUAL CELEBRATION! WE'VE TAKEN INSPIRATION FROM OUR FAMOUS SUNDAY BOTTOMLESS BRUNCH TO CREATE AN ANYTIME HIGH TEA PLATTER - ALLOWING GUESTS TO CASUALLY GRAZE THROUGHOUT THE EVENT (AND LEAVE PLENTY OF ROOM FOR COCKTAILS!)

SOUTHBEACH ANYTIME HIGH TEA

\$80 Share between 2

With a select range of danishes, profiteroles and cakes baked on site, our Southbeach high tea tower has a little something for everyone. Mixed mini sandwiches and toasted brioche with crumbled fetta together with poached eggs benedict on a toasted croissant bring us the savoury selection, while assorted danishes, custard filled profiteroles and individual petit fours make up the sweets selection.

CHARCUTERIE BOARDS

\$40 Small

\$80 Large

A selection of fresh and dried fruits, meats, cheeses and crackers... this charcuterie tower will certainly spark your guests' appetite!

Meats: Tart prosciutto, rich Italian salami, Sopressa leg ham.

Cheeses: Tasmanian blue cheese, smooth Havarti, sharp aged English cheddar.

Fruits: Dried apples, dates, fresh figs and strawberries.

Crackers: Crunchy bread sticks, lavosh crackers and a sweet quince paste.

Our charcuterie boards come in small and large sizes, to suit all sized groups.

For more information on our weekly bottomless brunch, visit our website!



Beverage Packages

HOUSE

WINE

MORGAN'S BAY SPARKLING CUVÉE VIC
 MORGAN'S BAY SEMILLON SAUVIGNON BLANC VIC
 MORGAN'S BAY CABERNET MERLOT VIC

BEER

XXXX GOLD
 BYRON BAY PREMIUM LAGER
 HAHN SUPER DRY
 JAMES SQUIRE 150 LASHES
 SOUTHBEACH PALE ALE
 MONTEITHS CRUSHED APPLE CIDER
 HAHN PREMIUM LIGHT

2 HOURS	\$38 PER PERSON
2 HOURS [ADD HOUSE SPIRITS]	\$50 PER PERSON
3 HOURS	\$48 PER PERSON
3 HOURS [ADD HOUSE SPIRITS]	\$65 PER PERSON
4 HOURS	\$58 PER PERSON
4 HOURS [ADD HOUSE SPIRITS]	\$75 PER PERSON

*NO SHOTS PERMITTED.

PREMIUM

COCKTAILS

WHITLEY NEILL APPLE & PEAR SPRITZ
 WHITLEY NEILL RASPBERRY SPRITZ
 WHITLEY NEILL RHUBARB & ROSE SPRITZ

WINE

MORGAN'S BAY SPARKLING CUVÉE VIC
 RIVANI PROSECCO ITALY
 MORGAN'S BAY SEMILLON SAUVIGNON BLANC VIC
 CHARLOTTE'S PARADISE SAUVIGNON BLANC USA
 BELOW THE CLOUDS PINOT GRIS NZ
 CHAIN OF PONDS CHARDONNAY SA
 VAL DE LOIRE ROSE FR
 MORGAN'S BAY CABERNET MERLOT VIC
 HITHER & YON SHIRAZ SA

BEER

XXXX GOLD
 BYRON BAY PREMIUM LAGER
 HAHN SUPER DRY
 JAMES SQUIRE 150 LASHES
 SOUTHBEACH PALE ALE
 MONTEITH'S CRUSHED APPLE CIDER
 STONE AND WOOD PACIFIC ALE
 STELLA ARTOIS
 EUMUNDI GINGER BEER
 HAHN PREMIUM LIGHT

2 HOURS	\$65 PER PERSON
2 HOURS [ADD HOUSE SPIRITS]	\$75 PER PERSON
3 HOURS	\$75 PER PERSON
3 HOURS [ADD HOUSE SPIRITS]	\$90 PER PERSON
4 HOURS	\$85 PER PERSON
4 HOURS [ADD HOUSE SPIRITS]	\$105 PER PERSON



Minimum Spends

JANUARY - JULY		
	MON-THUR	FRI-SUN
BUNGALOW ROOM	\$2,500	\$4,000
SUNSET BAR	\$2,000	\$3,000
LOWER BEACH DECK	\$1,000	\$1,500
SUNSET LOUNGE #1	\$600	\$750
SUNSET LOUNGE #2	\$600	\$750
CABANA LOUNGE	\$600	\$750

AUGUST		
	MON-THUR	FRI-SUN
BUNGALOW ROOM	\$2,500	\$4,250
SUNSET BAR	\$2,000	\$3,250
LOWER BEACH DECK	\$1,000	\$1,500
SUNSET LOUNGE #1	\$600	\$750
SUNSET LOUNGE #2	\$600	\$750
CABANA LOUNGE	\$600	\$750

SEPTEMBER - OCTOBER		
	MON-THUR	FRI-SUN
BUNGALOW ROOM	\$2,500	\$4,500
SUNSET BAR	\$2,000	\$3,500
LOWER BEACH DECK	\$1,500	\$2,000
SUNSET LOUNGE #1	\$750	\$900
SUNSET LOUNGE #2	\$750	\$900
CABANA LOUNGE	\$750	\$900

NOVEMBER - DECEMBER			
	MON-THUR	FRI-SUN	FRI/SAT (DAY)
BUNGALOW ROOM	\$4,000	\$7,000	\$6,000
SUNSET BAR	\$3,000	\$5,000	\$4,000
LOWER BEACH DECK	\$2,000	\$2,500	\$2,500
SUNSET LOUNGE #1	\$900	\$1,100	\$1,100
SUNSET LOUNGE #2	\$900	\$1,100	\$1,100
CABANA LOUNGE	\$900	\$1,100	\$1,100

MAX CAPACITIES	
BUNGALOW ROOM	100 COCKTAIL OR 50 SEATED
SUNSET BAR	70 COCKTAIL
LOWER BEACH DECK	40 COCKTAIL
SUNSET LOUNGE #1	12 GUESTS
SUNSET LOUNGE #2	12 GUESTS
CABANA LOUNGE	12 GUESTS

SEATING TIMES

12pm - 5pm or 6pm -11pm.
If you would like to cross over both booking times, double minimum spend is required.

DEPOSITS

If total cost is under \$5,000, a \$1,000 deposit is required. For events of \$5,000 and above, 20% of min spend is required. Outstanding balance is due Wednesday week prior to function date.

Public Transport

SOUTH BANK TRAIN STATION, SOUTH BRISBANE TRAIN STATION & SOUTH BANK BUSWAY.

Parking

SOUTH BANK PARKLANDS CAR PARK

Little Stanley St, South Brisbane QLD 4101

**Approximately 2 minute walking distance*

SW1 SECURE CAR PARK

32 Cordelia St, South Brisbane QLD 4101

**Approximately 10 minute walking distance*

PERFORMING ARTS CENTRE CAR PARK

8 Melbourne St, South Brisbane QLD 4101

**Approximately 8 minute walking distance*

BRISBANE CONVENTION & EXHIBITION CENTRE

Glenelg St, South Brisbane QLD 4101

**Approximately 7 minute walking distance*





SOUTHBEACH

SIP, SAVOUR & SOCIALISE

0401 278 562

EVENTS@SOUTHBEACH.NET.AU

SOUTHBEACH.NET.AU

f SOUTHBEACHBRISBANE

@ SOUTHBEACH_BNE

30AA STANLEY STREET PLAZA, SOUTH BRISBANE QLD 4101